

# WTA

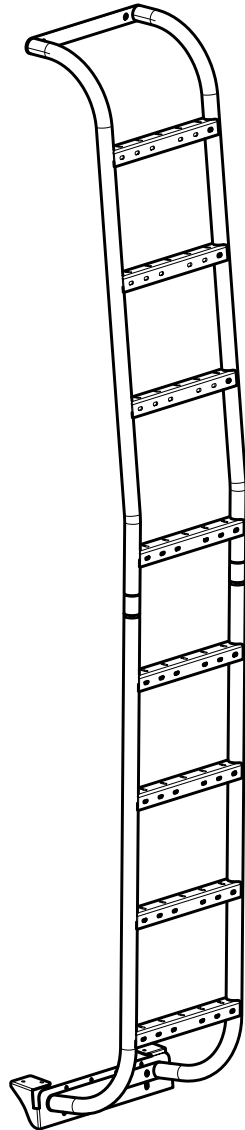

## Installation Guide



## PROMASTER SIDE LADDER PM-159HRL

It is crucial to ensure that all WTA products are assembled and securely attached to your vehicle. Failure to do so may result in automobile accidents, posing a significant risk of bodily injury or even death to yourself and others. As the owner, it is your responsibility to properly assemble and secure WTA products, diligently inspecting the mounting points and attachments before use, and regularly checking for any signs of wear or damage.

To guarantee optimal safety, we strongly advise engaging the services of a professional installer for the installation of any aftermarket accessories to your vehicle. If you lack mechanical experience or are unfamiliar with the installation procedures, it is imperative to have the product installed by a qualified professional or individuals who possess the necessary expertise. Remember, the responsibility lies with you, and it must be taken seriously to ensure the safety of all individuals involved.

# PACKAGE CONTENTS

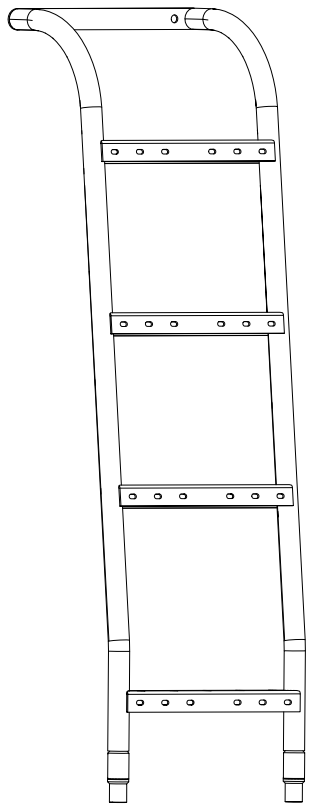

UPPER LADDER SECTION  
QTY-1

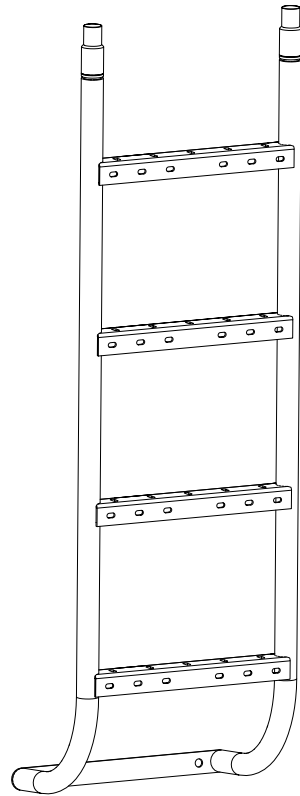

LOWER LADDER SECTION  
QTY-1

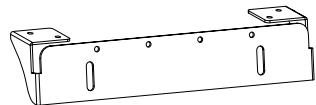

LOWER MOUNTING PLATE  
QTY-1

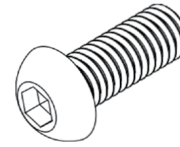

M10-40mm BUTTON HEAD SCREW  
QTY:4



M10 FLAT WASHER  
QTY:8

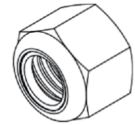

M10 NYLON LOCK NUT  
QTY:4

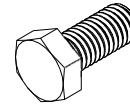

M6-20mm HEX HEAD SCREW  
QTY:4



M6 FLAT WASHER  
QTY:8

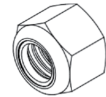

M6 NYLON LOCK NUT  
QTY:4

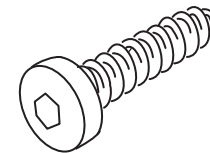

ST5.5-19mm SELF TAPPING SCREW  
QTY4

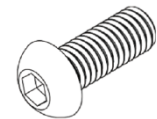

M6-16mm BUTTON HEAD SCREW  
QTY:4

# INSTALL

## STEP 01 LADDER ASSEMBLED

1.1 SLIDE THE TWO HALVES OF THE LADDER TOGETHER AND TIGHTEN DOWN WITH (4x) **M6-16 BUTTON HEAD SCREW**

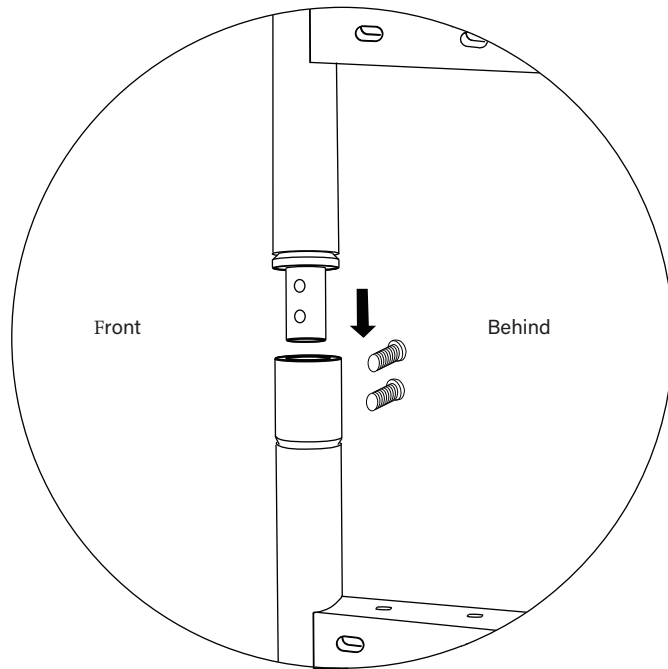
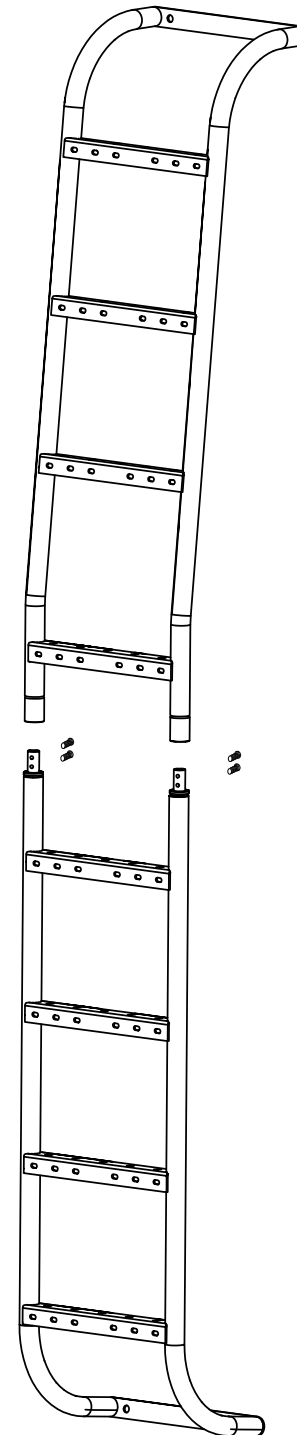

FIGURE 1



## STEP 02 INSTALL ON THE RAILS

**2.1** PLACE THE LADDER AGAINST THE SIDE OF YOUR ROOF RACK, ALIGNING THE TWO HOLES ON THE TOP OF THE LADDER WITH THE TWO SLOTS FOR THE LADDER ON THE ROOF RACK. SLIDE (2x) **M10-40 BUTTON HEAD SCREWS** AND (2x) **M10 FLAT WASHERS** FROM THE THE LADDER SIDE INTO THE ROOF RAIL SLOTS.

**2.2** LOOSELY SCREW THE TOP OF THE LADDER DOWN TO THE ROOF RAIL USING THE **M10-40 BUTTON HEAD SCREWS**, **M10 FLAT WASHER** AND (2x) **M10 NYLON LOCK NUTS**

**NOTE:** WE LIKE TO PLACE THE LADDER AS CLOSE TO THE REAR WHEEL AS POSSIBLE.

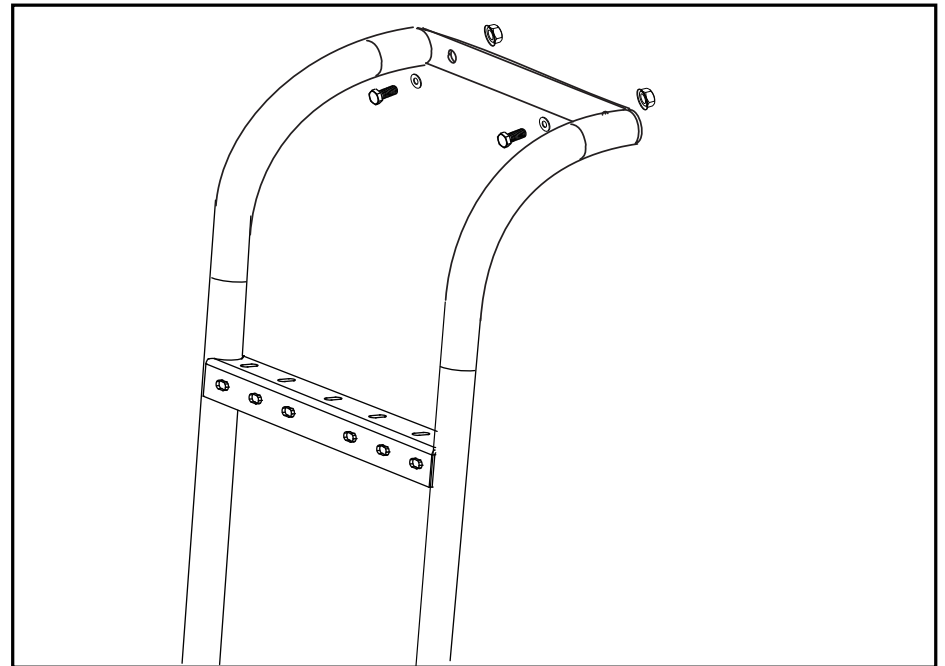
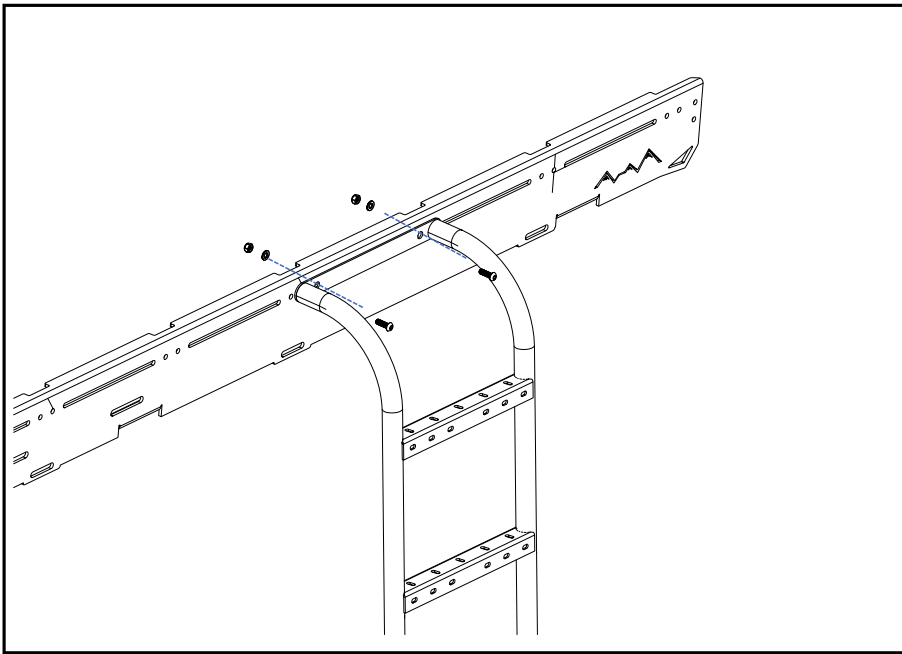

## STEP 03 MOUNT PLATE

**3.1 TAKE THE MOUNT PLATE AND LOOSELY ATTACH IT TO THE BOTTOM LADDER USING THE OTHER (2x) M10-40 BUTTON HEAD SCREWS, M10 WASHERS AND M10 NYLOCK NUTS**

**3.2 PLACE YOUR LOWER MOUNTING BRACKET AND CHECK THAT THE LADDER IS VERTICAL AND IN THE DESIRED LOCATION.**

**3.3 LINE UP THE LOWER MOUNT BRACKET, MARK THE HOLE LOCATION WITH A PEN AND DRILL 4 HOLES WITH 1/4 INCHES DRILL BIT THROUGH YOUR VANS PINCH WELD**

**NOTE: MAKE SURE THE LADDER IS STRAIGHT UP AND DOWN**

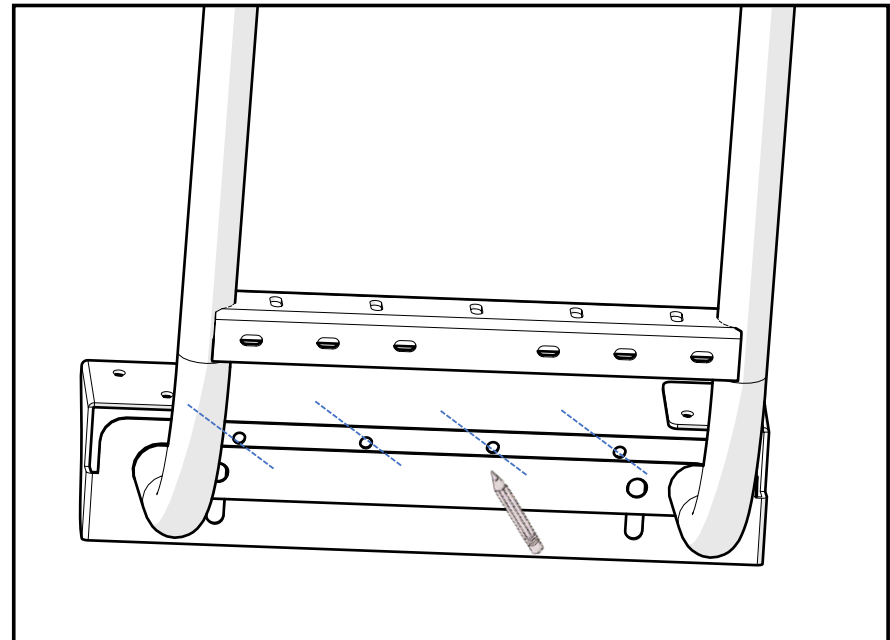
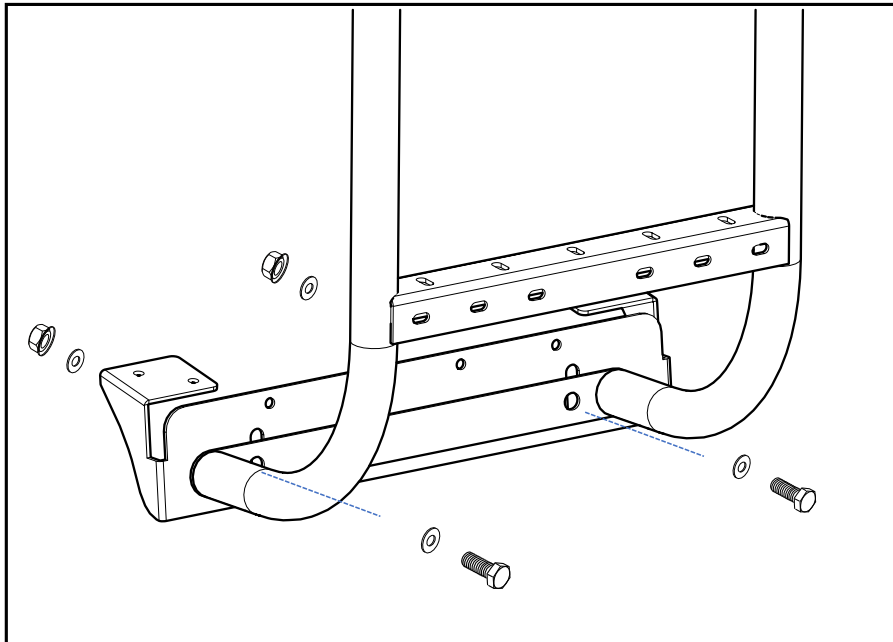

## STEP 04 MOUNT PLATE

**4.1** LINE UP THE MOUNT PLATE WITH THE HOLES YOU DRILLED IN YOUR VAN, THEN PLACE THE (4x) **M6-20 HEX HEAD SCREWS** THROUGH THE HOLES WITH **M6 WASHERS** ON BOTH SIDES THEN ONCE ALL ARE IN PLACE LOOSLY TIGHTEN DOWN WITH THE **M6 NYLOCK NUTS**

**NOTE:** SHOULD HAVE PLAY BUT NOT SO LOOSE IT IS FLOPPING AROUND

**4.2** USE THE (4x) **ST5.5 SELF TAPPING SCREWS** AND WHILE UNDER THE VAN DRILL THEM UP THROUGH THE HOLES IN THE LOWER BRACKET INTO THE LOWER SHEET METAL OF THE VAN TUNNEL.

**4.3** NEXT TIGHTEN DOWN THE (4x) **M6\*20 HEXAGON HEAD SCREW** WITH THE **M6 NYLON LOCK NUT**.

**4.4** FINALLY TIGHTEN DOWN THE (4x) **M10-40 BUTTON HEAD SCREWS** ON THE (2x)TOP AND (2x)BOTTOM OF THE LADDER. CHECK THAT ALL SCREWS ON THE BRACKET AND LADDER ARE NOW TIGHTENED DOWN PROPERLY.

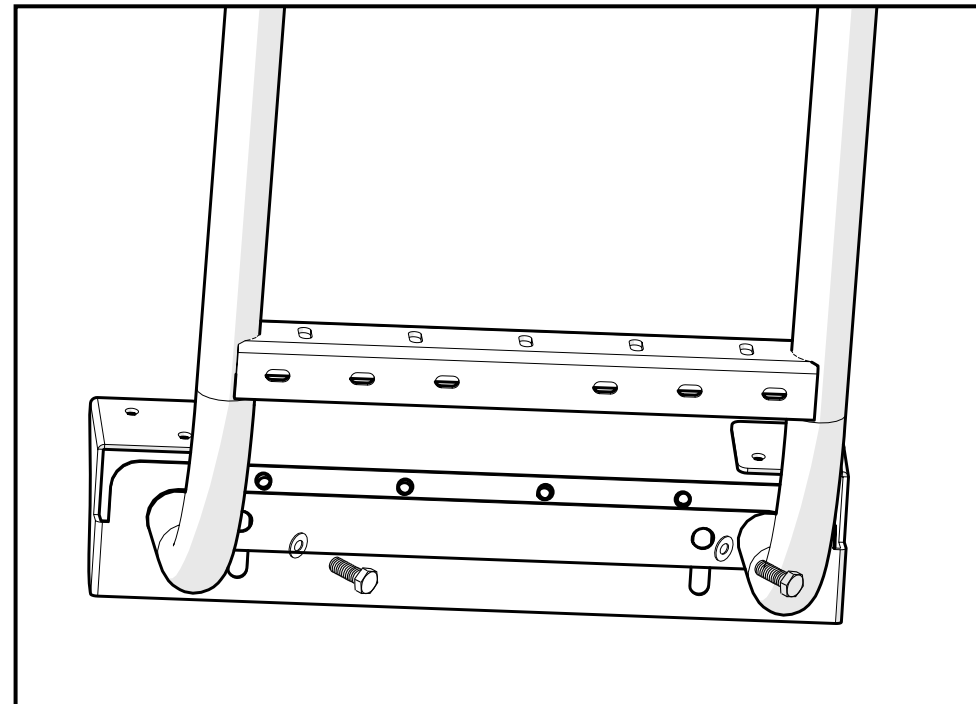
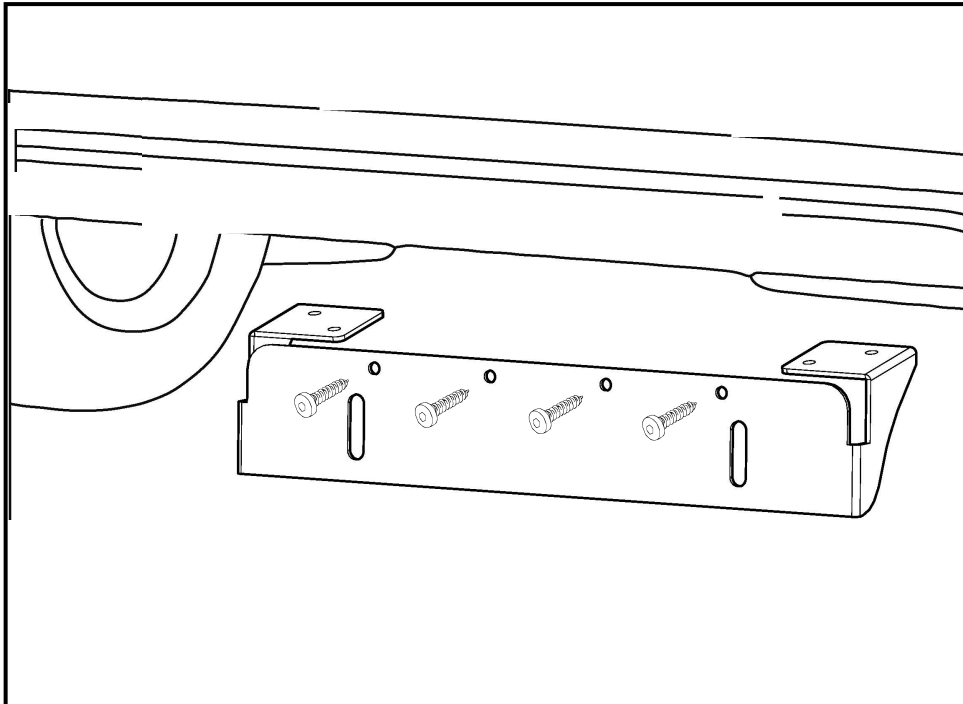

# GET THERE WITH WHITE TOP ADVENTURES



thanks!



[info@whitetopadventures.com](mailto:info@whitetopadventures.com)